



## Detached Bungalow

Hythe, SO45 5DN

- FANTASTIC VIEWS
- SOUGHT AFTER LOCATION
- THREE DOUBLE BEDROOMS
- POSSIBILITY TO EXTEND (STP)
- WALK TO HYTHE VILLAGE CENTRE
- DETACHED BUNGALOW
- FITTED KITCHEN WITH GARDEN ACCESS
- NEWLEY DECORATED FAMILY BATHROOM
- GARAGE AND DRIVE FOR TWO CARS
- FENCED IN AND SUNNY BACK GARDEN

Guide price £375,000 Freehold





### **Kitchen**

The kitchen has direct access to the back garden and a window with views over the water.

### **Living Room**

The bungalow boasts a living room that is both inviting and versatile, providing a comfortable area for relaxation or entertaining guests.

### **Bathroom**

This practical bathroom includes a large shower, sink, and toilet as well as a convenient shelf, providing ample storage space.



### **Bedroom 1**

With room for a double bed, this bedroom provides plenty of natural light with a large window facing the private garden.

### **Bedroom 2**

With room for a double bed, this bedroom provides plenty of natural light with a large window facing the private garden.

### **Bedroom 3**

The third bedroom has a large window facing the sizable front garden and water.





Local Authority **NFDC**  
Council Tax Band **D**  
EPC Rating **D**

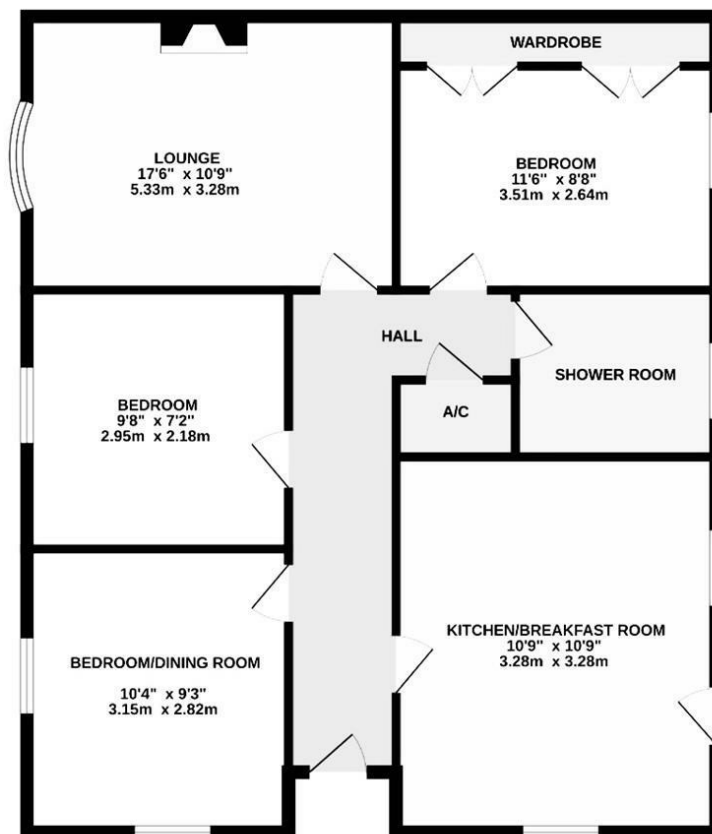

Whilst every attempt has been made to ensure the accuracy of the description contained here, measurements of doors, windows, rooms and any other details are approximate and no responsibility is taken for any error, omission or mis-statement. This plan is for illustrative purposes only and should be used as such by any prospective purchaser. The services, systems and appliances shown have not been tested and no guarantee as to their operability or efficacy can be given.  
Made with Metropix 72023

### Citrine Estates Office

7 High Street, Hythe, Southampton,  
SO45 6AG

### Contact

023 81980 023  
christina@citrine-estates.co.uk  
www.citrine-estates.co.uk

Agents Note: Whilst every care has been taken to prepare these particulars, they are for guidance purposes only. All measurements are approximate and for general guidance purposes only and whilst every care has been taken to ensure accuracy, they should not be relied upon and potential buyers/tenants are advised to recheck the measurements.